

TECHNICAL SPECIFICATION

hushwork.sit&stand HUS-BX-116

YOUR OWN SPACE FOR INDIVIDUAL SUCCESS

HushWork is a new approach to individual work. It's a solution that allows you to create a dedicated space in which you can focus. Advanced acoustic solutions ensure high comfort for the user while increasing the feeling of privacy. This affects both the improvement of well-being and the effectiveness of performed tasks. HushWork is an important space for the entire organisation because as it isn't an assigned workspace it can be used by everyone!



DIMENSIONING



W/D/H: exterior 62.99 x 47.24 x 90.55 in
interior 54.44 x 44.05 x 79.52 in

Weight: 1030 lbs **Weight with crate:** 1265 lbs

Logistic data is available on request.

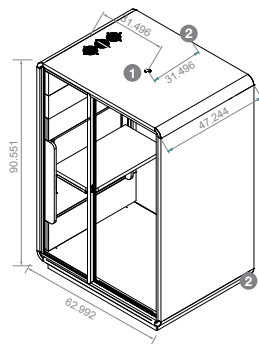

1 Cutout for sprinkler installation 2 Power cable access

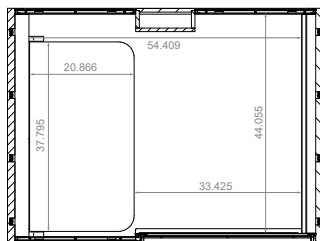

ELECTRIFICATION

LED ceiling light.

Power module: UL standard: 1x (power, RJ 45, USB Type A 2.4A, USB Type C 5A). Black color.

Motion sensor: activating lighting and airflow at 50% power. Located in the ceiling. Standby power consumption 0.3 W.

Power cable: access from ceiling or base (detailed information can be found in the Assembly Manual). 2.36 in milling prepared from the inside of the ceiling (not visible from outside). White cable with three-prong grounded plug 110V. The total length of the cable – 14.78 ft. The cable length for the exit of unit – 11.82 ft.

RJ45 cable: the total length of the cable – 7.88 ft. The cable length for the exit of unit – 4.60 ft.

Maximum power consumption of the product 42 W.

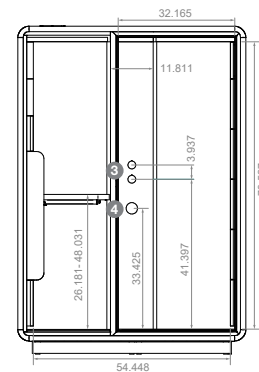

3 Lighting and ventilation adjustment knobs 4 Power module

LIGHTING

Ceiling light 17 W/1550 lm. 3000 K. Avg. [lux] 128. Min. [lux] 87. Max. [lux] 161.*

* Calculation results of the LED light source on the tabletop inside the booth.
The final amount of Lux depends on the lighting intensity in the office space.

VENTILATION

3 fans. 1660 ft³/h* / 293 seconds**.

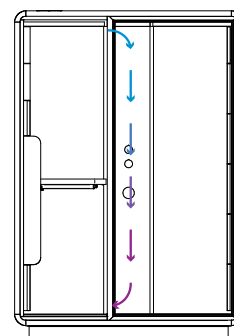

* maximum performance of the single fan, taking into account losses in the ventilation system.
** total time of air change inside based on the volume and capacity of one fan.

TECHNICAL SPECIFICATION

hushwork.sit&stand HUS-BX-116

EXTERIOR

GLASS DOOR with LATCH HANDLE: acoustic, tempered and laminated safety glass 0.39 in, 5.5.2 thickness including the thickness of 0.19 in glass, 0.07 in acoustic sheet and 0.19 in glass. Clear color.

FRONT AND REAR SIDE GLASS PANELS: acoustic and laminated glass 0,39 in (RW= 35 dB), 5.5.2 thickness including the thickness of 0.19 in glass, 0.07 in acoustic sheet and 0.19 in glass. Placed in aluminum profiles with acoustic seal. Clear color. Frosted rear glass – optional.

The glass door is always equipped **with anti-collision markings**. Exact dimensioning is available on request.

PROFILES: for glass and door frame in cosmos grey color.

DOOR HANDLE AND HINGES: anodized aluminum or aluminum painted in cosmos grey color.

CASE: 3-layer honeycomb board with a thickness of 1.49 in. Both sides covered with melamine and finished with ABS edging.

Removable base cover providing space for pallet jack access.

2.36 in hole with grommet for sprinkler installation.

INTERIOR

TABLE: (W/D) 37.79 x 20.86 in.

Manual, height adjustable worktop made of 3 layer honeycomb board, 1.5 in thickness, both sides melamine covered, and finished with ABS edging.

Maximum static load of table – **10 kg / 22 lbs.**

Maximum dynamic load of table – **7,5 kg / 16 lbs.**

INTERIOR PANELS: high-density LDF (HDF) 0.12 in thickness, covered with non-flammable polyurethane foam. Upholstered.

FLAME RETARDANT FOAM: complies with BS 5852: Part 2: 1982, Ignition source 5 (Crib 5).

UPHOLSTERY Wool:

weight: 325 g/m², **composition:** 70%WO, 20%PL, 5%PA, 5%AF, **flammability:** cigarette and match (BS-EN 1021-1, 2) (BS 5852-0, 1), CAL 117 (class 1), ASTM 84 (class 1), **light fastness:** 5 (EN ISO 105B02), **fastness to rubbing:** wet: 4/5; dry: 4/5 (ISO 105-X12), **abrasion resistance:** 100.000 martindale cycles (EN ISO 12947-2).

INTEGRAL CARPETED FLOOR.

CARPET: complies with ASTM D2859 – 16 (2021), standard test method for ignitability characteristics of finished textile floor covering materials. Adapted to commercial intensive use (hotel room, hotel suite, boutique, shop, restaurant, conference room, high traffic office, reception, stairs). Graphite color.

ACOUSTIC RATING

Frequency range 125 Hz to 8000 Hz according to ISO 23351-1:2020. Speech level reduction – D_{sA} 27 (dB).

SEISMIC ANCHORAGE

Product with Seismic Anchoring capability as standard solution. Instructions on how to anchor are available on request.

SUSTAINABILITY

Hushoffice booths are manufactured in a ISO 9001 and 14001 certified production facility in Poland by Mikomax Smart Office. They are compliant with the ISO 14001 Environmental Management System Standard. Hushoffice is packed and delivered in light cardboard boxes which are recycle-friendly.

CERTIFICATION



Warranty



Made in EU



Premium wool
CAL 117



Certificates



In October 2020 ICC-ES Acceptance Criteria 519 "Enclosed Booths for Installation Inside New and Existing Buildings" (AC 519) were published. AC 519 covers all the relevant building code issues that office pods have faced. All HushOffice acoustic pods are substantially compliant with the requirements of AC 519, except for 32" clear opening width (HushPhone, HushMeet, HushTwin, HushWork and HushLarge) and the 80" door clear opening height requirement (HushPhone, HushHybrid, HushMeet, HushTwin, HushWork and HushLarge) of the IBC. The difference does not compromise the safety or egress possibilities of the occupants using the pod. Please remember that according to AC-519 if an enclosed booth does not comply with the means of egress, accessibility and interior space dimension requirements of IBC Chapters 10, 11 and 12, respectively, the plans must be submitted to, and approved by, the code official at the time of permit application.

Manufacturer: Fabryka Mebli Biurowych Mikomax sp. z o.o. | 93-231 Łódź ul. Dostawcza 4, Polska
Distributor: Mikomax sp. z o.o. | 93-231 Łódź ul. Dostawcza 4, Polska

hushoffice.com